

DPSS-1064-NL

INFRARED LASERS: 1064 nm, 100~1500 mW



- Miniature size
- Collimated straight beam
- Adjustable focus
- Easy use & maintenance free
- Longlife operation
- High efficiency
- High reliability

APPLICATIONS

- Thermal printing
- Material Inspection
- Scanning Biochemistry LIDAR

SPECIFICATIONS

Wavelength	1064 nm
Spatial Mode	TEM ₀₀
Output Power	>100, 200, ..., 1500 mW
Operation Mode	CW or Modulation
Modulation	Analog or TTL 1Hz ~ 30 kHz
Polarization	100 : 1
Beam Spot Shape	Circular, aspect ratio <1.1 : 1
Pointing Stability	<0.05 mrad
Beam Diameter (1/e ²)	2 mm
Beam Divergence	1.2 mrad
Power Stability	<±3% per 2 hrs
Temperature Stabilizing	TEC
Warm Up Time	<5 minutes
Beam Quality (M ²)	<1.2
Optimum Operating Temperature	20~30 °C
Storage Temperature	10~50 °C
Expected Lifetime	10,000 hrs
Laser Head Dimensions	40(W) × 100(L) × 50(H) mm (optional fan adds 15 mm height)
POWER SUPPLY	
OEM type EO-PS-I	58(W) × 100(L) × 32(H) mm AC/DC PSU: 85~265 V 50/60 Hz input
Lab type EO-PS-IIS	104(W) × 128(L) × 89(H) mm 85~265V 50/60 Hz input
Lab Adjustable type EO-PS-II	179(W) × 148(L) × 56(H) mm 85~265 V 50/60 Hz input

ORDERING INFORMATION

Catalogue number	Description
DPSS-1064-NL100	100 mW
DPSS-1064-NL200	200 mW
DPSS-1064-NL300	300 mW
DPSS-1064-NL400	400 mW
DPSS-1064-NL500	500 mW
DPSS-1064-NL600	600 mW
DPSS-1064-NL700	700 mW
DPSS-1064-NL800	800 mW
DPSS-1064-NL900	900 mW
DPSS-1064-NL1000	1000 mW
DPSS-1064-NL1200	1200 mW
DPSS-1064-NL1500	1500 mW
EO-PS-I	OEM Type power supply
EO-PS-IIS	Lab type power supply
EO-PS-II	Lab adjustable type power supply

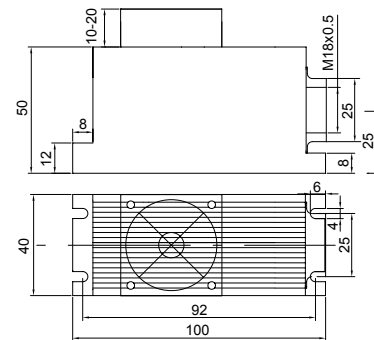

DPSS-1064-NL

RELATED PRODUCTS

Laser Safety Eyewear
See page 1.16.



Visualizator 990-0840
See page 1.16



POWER SUPPLIES

- OEM power supply **EO-PS-I**
- Lab type power supply **EO-PS-IIS**
- Lab adjustable type power supply **EO-PS-II**

